

# CARBON FIBER AIR INTAKE SYSTEM

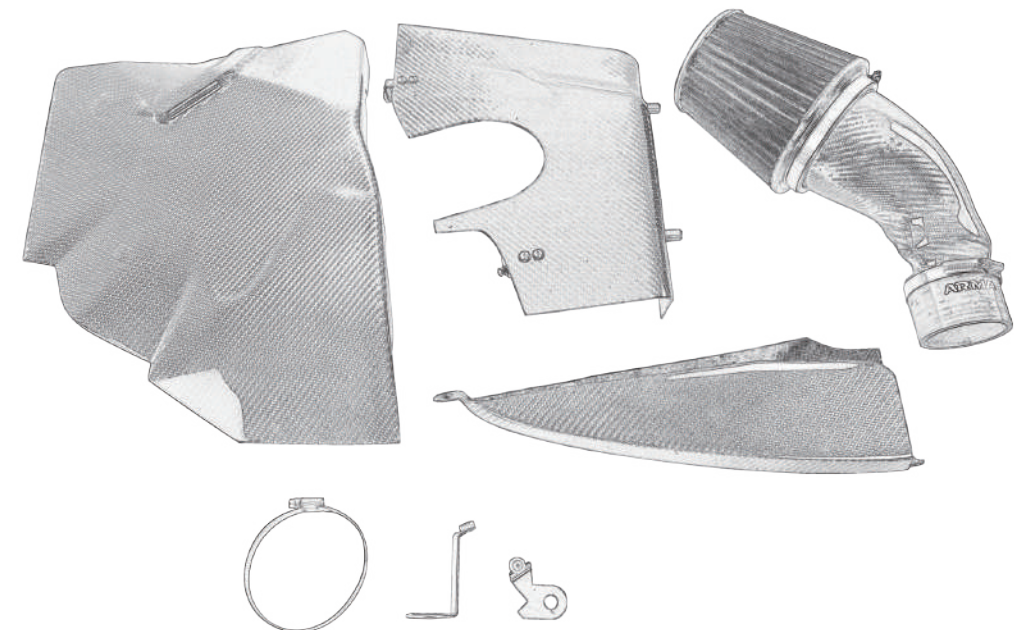

## AUDI S5 B9 3.0T

### USER MANUAL

## ARMASPEED Warranty Terms & Conditions

### »»»» Warranty Period

The warranty covers the product mechanically within 6 months or 10,000 km, whichever comes first, from the purchase date. Non-transferable.

### »»»» Disclaimer of Warranty

1. To accommodate the regional climate, most of car manufacturing companies would slightly adjust ECU. Changing intake or exhaust system might cause engine lights on. Under the premise that it wouldn't cause engine lights on, the purpose of the product is to bring out the best in energy efficiency. ARMASPEED will not guarantee or offer a warranty for the road feel or product impressions due to gears change, torque limit, engine light on, etc. Please kindly understand any modification may cause risk.
2. The product is designed to improve car performance for daily driving. The warranty would be void if the product is used in a race or competition.
3. The warranty does not cover any damage caused in whole or in part by force majeure or harsh driving.
4. ARMASPEED shall NOT be liable for incidental or consequential damages whatsoever and in no case shall the ARMASPEED be responsible for any damages exceeding the original purchase price of the product.
5. The warranty would be void if the user drills, trims, paints, modifies, etc., the product or change the function and appearance.
6. All performance parts or systems should be installed by mechanics who are experienced in installation and proper operation. The warranty would be void if the product is misused, the user alters the design and disassembles without authorization of ARMASPEED, or the user fails to follow the ARMASPEED's instructions to install and maintain.

### »»»» Limited Warranty

ARMASPEED warrants to the original purchaser that the product is free of manufacturing defects in materials and workmanship in the limited duration. If the product is found to be defective, in the ARMASPEED's sole judgment, it would be either repaired or replaced with a new product, and the original purchaser shall be liable for return shipping/handling fees. If the product is out of production, ARMASPEED would only repair, but not replace it with other new product.

Purchaser understands and agrees only ARMASPEED has the right to amend the terms of use, and any performance car shops and authorized dealers cannot void the statement.

If you have any questions about our warranty terms, please send an email at [service@armaspeed.com](mailto:service@armaspeed.com).

Tel: +886-6-5930028 Web: [www.armaspeed.com](http://www.armaspeed.com)

The following have already been assembleda			
Drawing No.	Part	No.	Quantity
11	tube - innter diameter 70mm.L-60mm	CS53-AR50016	1
12	AUDI S5-aluminum braket -1	CG83-01-0477	1
13	AUDI S5-aluminum braket -3	CG83-01-0507	1
14	AUDI S5-aluminum braket -4	CG83-01-0508	1
15	AUDI S5-aluminum braket -5	CG83-01-0509	1
16	CAP M4*8mm Screws	CG46-10-0293	4
17	M4mm Washers	CG48-10-0023	4
18	M4 Spring Washers	FG55-01-0042	4
19	AUDI S5 rubber tube - PE black L43*W11	CS61-01-0036	2
20	CAP M6*30mm Screws	FG55-01-0250	2
21	M6 Spring Washers	CG48-20-0006	2
22	M6mm Washers	CG48-10-0017	2
23	M4 Blind jack nut	CG46-10-0292	1
24	Metal nameplates	CG40-10-0005	1
25	n type rubber	CS50-01-0008	1
26	CAP M4*16mm Screws	CG46-90-0003	3
27	M4mm Washers	CG48-10-0023	3
28	M4 Spring Washers	FG55-01-0042	3
29	CAP M4*12mm Screws	CG46-10-0079	1
30	M4mm Washers	CG48-10-0023	1
31	M4 Spring Washers	FG55-01-0042	1

DIY Part			
Drawing No.	Part	No.	Quantity
1	AUDI S5- Inboc	ARMAAD00S5-1	1
2	AUDI S5- front slam panel	ARMAAD00S5-2	1
3	AUDI S5- pipe	ARMAAD00S5-3	1
4	AUDI S5- upper cover	ARMAAD00S5-4	1
5	air filter 148 height 114 diameter	CS56-AR60031	1
6	110-130 mm Hose Clamp	CG45-10-0010	1
7	CAP M4*60mm Screws	FG55-03-0014	1
8	M4mmWashers	CG48-10-0023	1
9	M4 Spring Washers	FG55-01-0042	1
10	70-90mm Hose Clamp	CG45-10-0002	2
32	AUDI S5-6 aluminum braket	CG83-01-0522	1



AUDI S5 B9 3.0T



All performance parts or systems should be installed by mechanics who are experienced in installation and proper operation. The warranty would be void if the product is misused, the user alters the design and disassembles without authorization of ARMASPEED, or the user fails to follow the ARMASPEED's instructions to install and maintain.

**1** Remove the stock inbox, induct and front slam panel

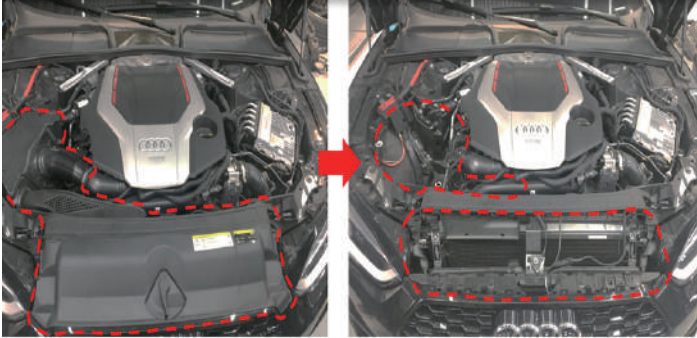

**2** Remove the stock blinth and install to Arma inbox

**3** Install ARMASPEED inbox as instructed

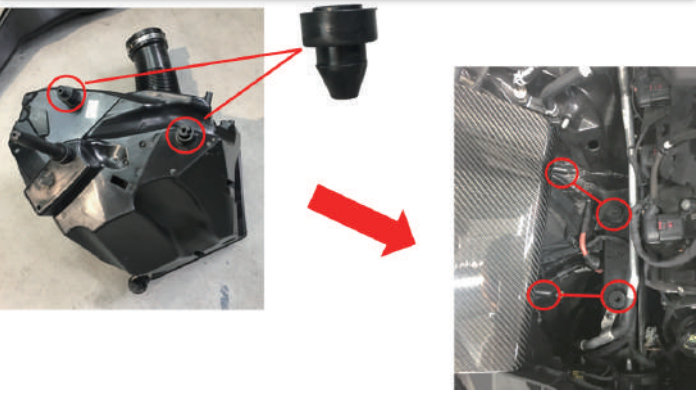

**4** Install ARMASPEED front slam panel, use no. 7, 8, 9 screw( only lock the instructed part)

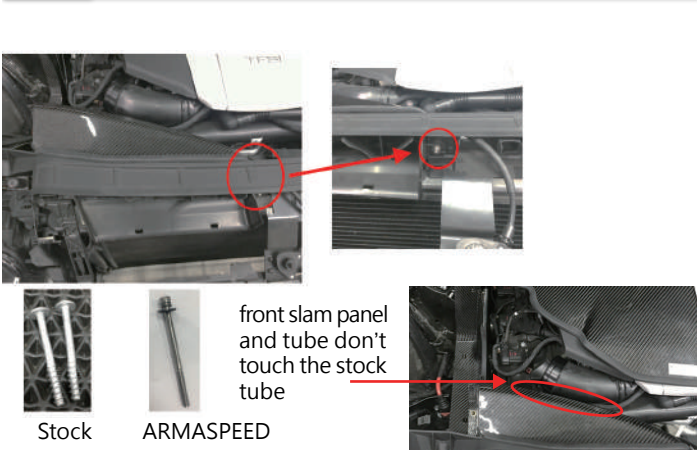

**5** Screw up front slam panel with screw no.29.30.31 and no.32 which are attached with Arma inbox



**6** Screw no. 12, 13 into instructed position

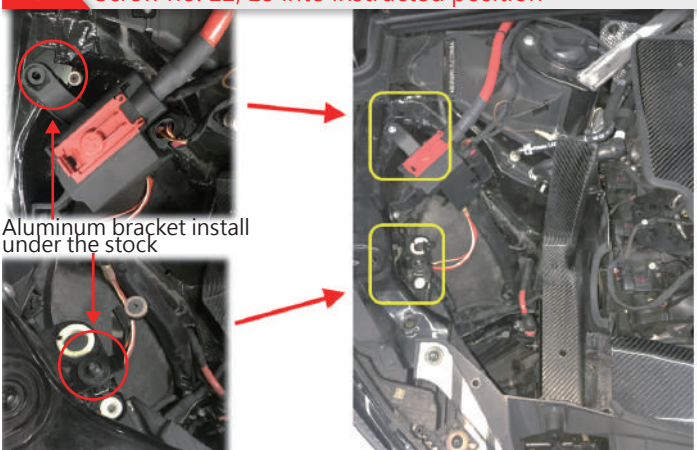

**7** ARMASPEED intake tube and air filter no. 5 and the other accessory lock together with no. 6, 10, 11

**8** Lock with stock tube



**9** Screw ARMASPEED upper cover as instructed with screw no. 26.27.28

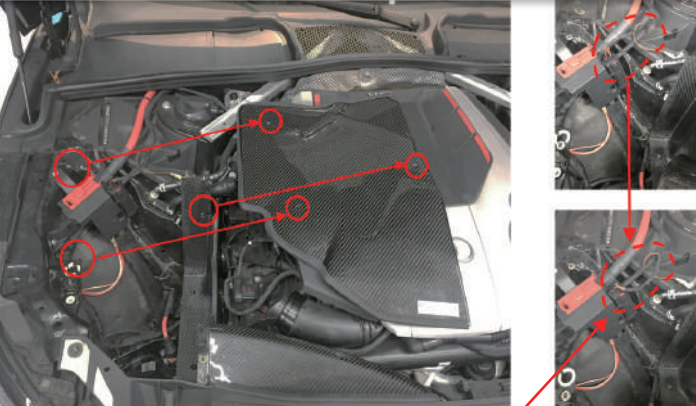

When install the upper cover, move the electrical a little further as red circle

Please adjust the upper cover and intake as below - ok status

OK



NG



**10** Installation completed



When fastening the metal hose clamp, recommend set tightening torque at 1.5Nm. Otherwise, it might result in deformation or crack if overtightening.

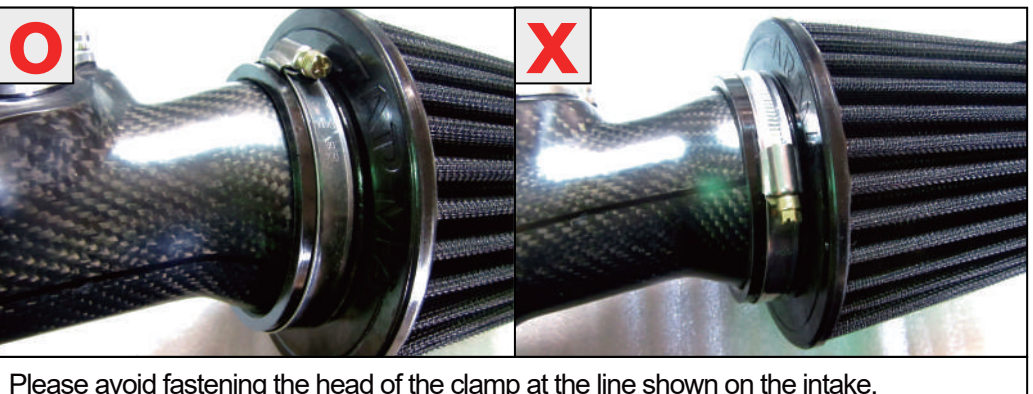

Please avoid fastening the head of the clamp at the line shown on the intake.