

CARBON FIBER AIR INTAKE SYSTEM

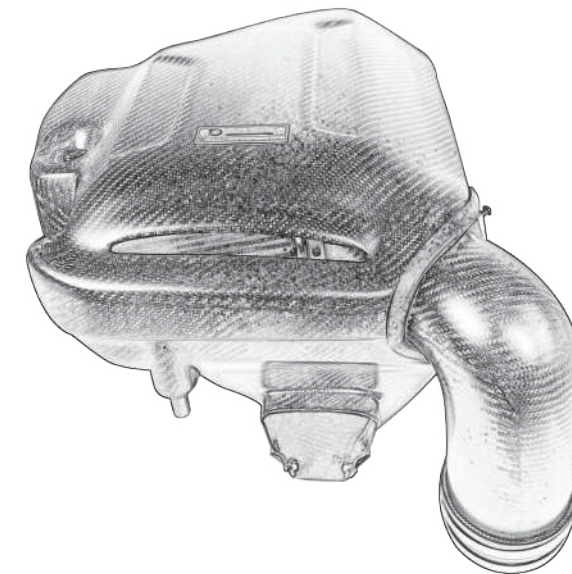

BMW F36 440i B58B30

USER MANUAL

ARMASPEED Warranty Terms & Conditions

Warranty Period

The warranty covers the product mechanically within 6 months or 10,000 km, whichever comes first, from the purchase date. Non-transferable.

Disclaimer of Warranty

- To accommodate the regional climate, most of car manufacturing companies would slightly adjust ECU. Changing intake or exhaust system might cause engine lights on. Under the premise that it wouldn't cause engine lights on, the purpose of the product is to bring out the best in energy efficiency. ARMASPEED will not guarantee or offer a warranty for the road feel or product impressions due to gears change, torque limit, engine light on, etc. Please kindly understand any modification may cause risk.
- The product is designed to improve car performance for daily driving. The warranty would be void if the product is used in a race or competition.
- The warranty does not cover any damage caused in whole or in part by force majeure or harsh driving.
- ARMASPEED shall NOT be liable for incidental or consequential damages whatsoever and in no case shall the ARMASPEED be responsible for any damages exceeding the original purchase price of the product.
- The warranty would be void if the user drills, trims, paints, modifies, etc., the product or change the function and appearance.
- All performance parts or systems should be installed by mechanics who are experienced in installation and proper operation. The warranty would be void if the product is misused, the user alters the design and disassembles without authorization of ARMASPEED, or the user fails to follow the ARMASPEED's instructions to install and maintain.

Limited Warranty

ARMASPEED warrants to the original purchaser that the product is free of manufacturing defects in materials and workmanship in the limited duration. If the product is found to be defective, in the ARMASPEED's sole judgment, it would be either repaired or replaced with a new product, and the original purchaser shall be liable for return shipping/handling fees. If the product is out of production, ARMASPEED would only repair, but not replace it with other new product.

Purchaser understands and agrees only ARMASPEED has the right to amend the terms of use, and any performance car shops and authorized dealers cannot void the statement.

If you have any questions about our warranty terms, please send an email at service@armaspeed.com.

Tel: +886-6-5930028 Web: www.armaspeed.com

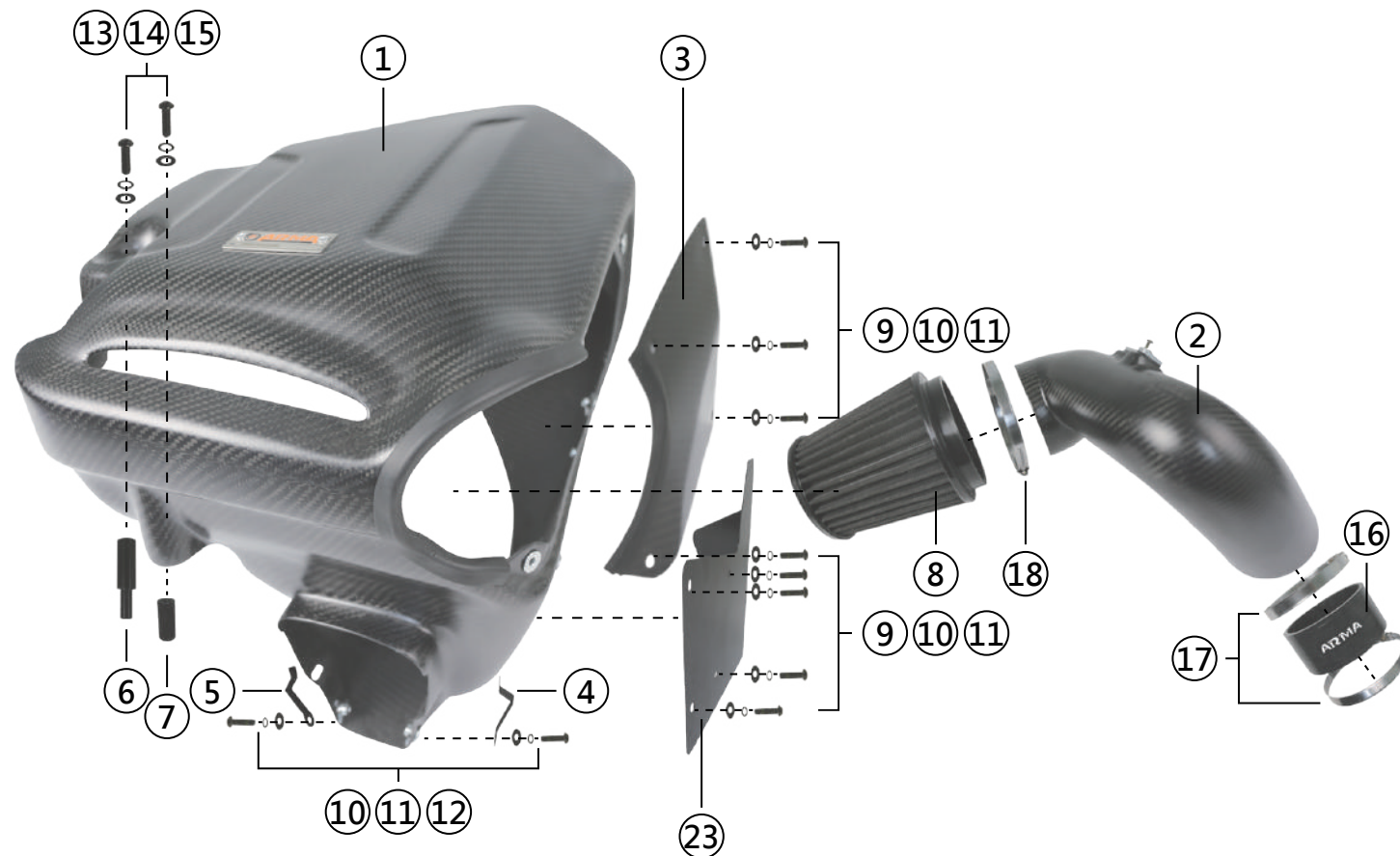

The following have already been assembleda

Drawing No.	Part	No.	Quantity
19	A4 B8 sensor seat	CG57-AR10080	1
20	n type rubber	CS50-01-0008	1
21	M4 BLIND JACK NUT	CG46-10-0292	10
22	Metal nameplates	CG40-10-0005	1
23	F36 440 B58 Insulated aluminum sheet	CG83-01-0391	1

DIY Part

Drawing No.	Part	No.	Quantity
1	F36 440 airbox	ARMABM3020-1	1
2	F36 440 pipe	ARMABM3020-2	1
3	F36 440 airbox side plate	ARMABM3020-3	1
4	F30 320 Air Intake Box Bracket-2	CG83-01-0369	1
5	F30 320 Air Intake Box Bracket-3	CG83-01-0370	1
6	F36 440i L80*W20 Hight Rubber tube	CS61-01-0023	1
7	12.7mmWide 30mm Hight Rubber tube	CG83-01-0081	1
8	Air Filter 148 Height X 114 Wide	CS56-AR60031	1
9	CAP M4*16mm Screws	CG46-90-0003	8
10	M4mm Washers	CG48-10-0023	10
11	M4 Spring Washers	FG55-01-0042	10
12	CAP M4*12mm Screws	CG46-10-0079	4
13	CAP M6*20mm Screws	CG46-10-0074	2
14	M6 Spring Washers	CG48-20-0006	2
15	M6mm Washers	CG48-10-0017	2
16	93mm to 93mm L-50 Silica Hose	CS53-AR50053	1
17	90-110mm Hose Clamp	CG45-10-0011	2
18	110-130mm Hose Clamp	CG45-30-0150	1



All performance parts or systems should be installed by mechanics who are experienced in installation and proper operation. The warranty would be void if the product is misused, the user alters the design and disassembles without authorization of ARMASPEED, or the user fails to follow the ARMASPEED's instructions to install and maintain.

1 Unplug the Mass Air Flow Sensor and remove it from the factory intake box.



After removal



4 Install the Mass air Flow Sensor to the Arma Intake Box.



2 Disassemble the intake box and the piping.



3 Secure the hose coupler on both end with clamps following the prefer torque setting.

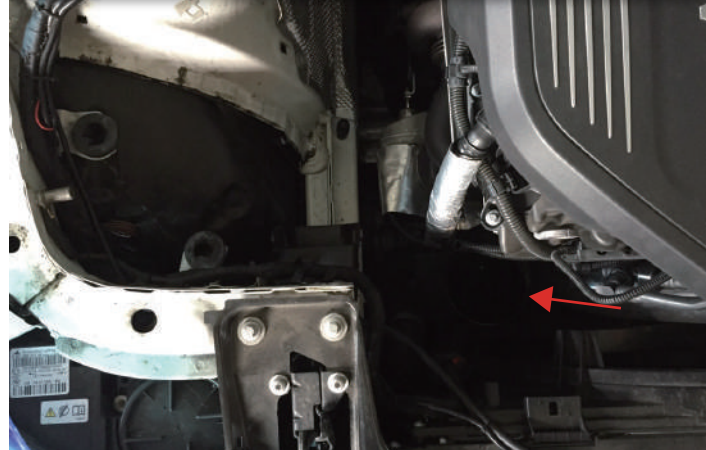

5 Match the stock location and install the Arma intake box into the engine bay, make sure the hose coupler is secure properly torque down.

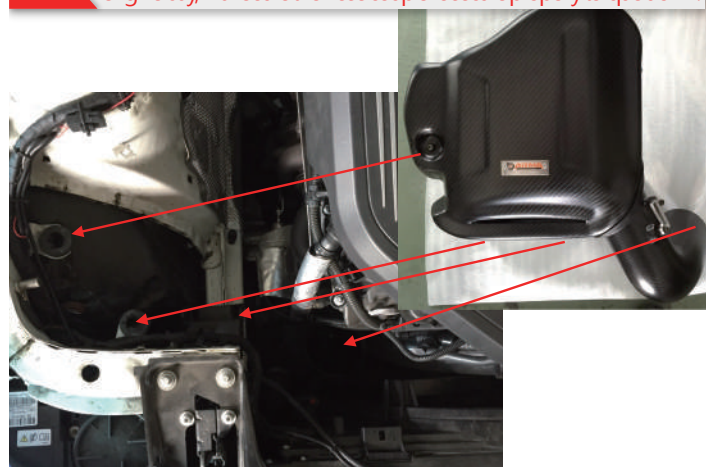

※When install the wiring harness, be careful if it will touch the intake; it needs to be reorganized till the wiring harness doesn't touch the intake



7 Installation completed.



6 Plug back the Mass Air Flow Sensor.

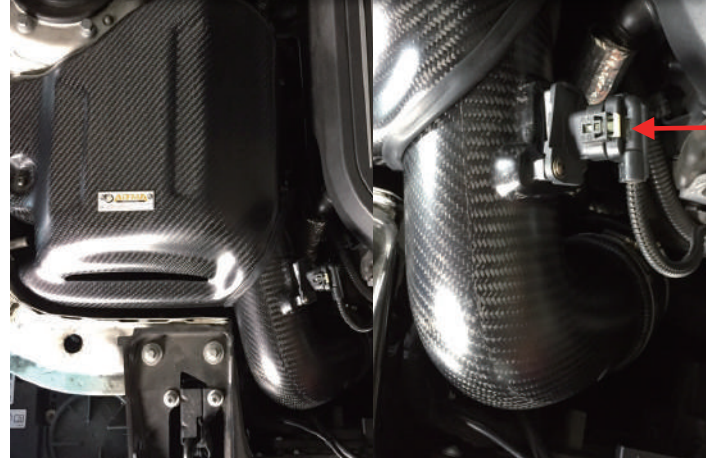

When fastening the metal hose clamp, recommend set tightening torque at 1.5Nm. Otherwise, it might result in deformation or crack if overtightening.

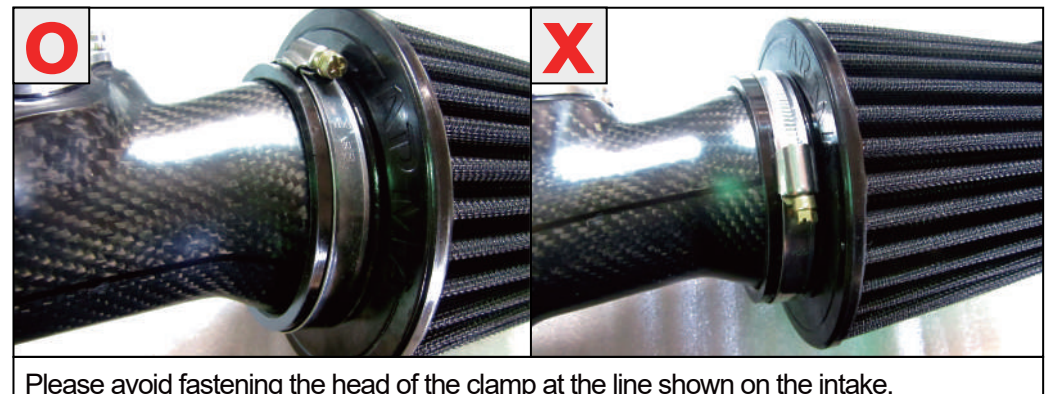

Please avoid fastening the head of the clamp at the line shown on the intake.